



Hi Tech Interface

Description: This tutorial will show you step by step how to create a nice looking hi-tech interface. You can use it for your website or softwares.

This is a fairly long tutorial, that is because I break it into step by step so even beginners will be able to get good results.

- Start a new document 600x200 and fill the background with #3E3F49.
- Select the **rectangle shape tool** and create a long horizontal bar like mine.

rectangle shape tool:

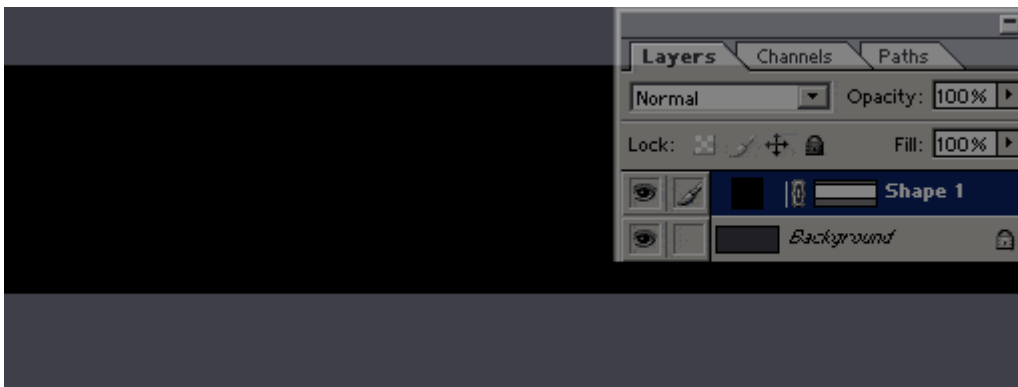
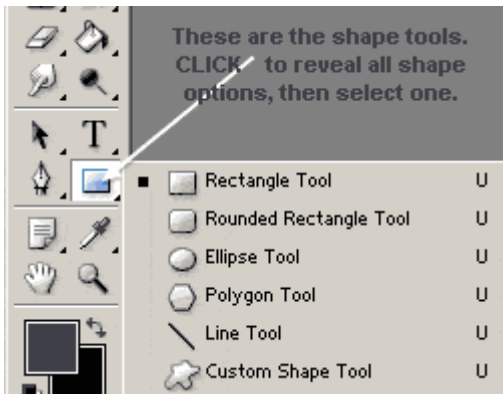

- Now apply the following layer styles to it:

DROP SHADOW:

Drop Shadow

Structure

Blend Mode: Multiply 

Opacity: 37 %

Angle:  120 ° Use Global Light

Distance: 5 px

Spread: 0 %

Size: 5 px

Quality

Contour:  Anti-aliased

Noise: 0 %

Layer Knocks Out Drop Shadow

| INNER SHADOW :

Inner Shadow

Structure

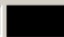
Blend Mode: Multiply 

Opacity: 72 %

Angle:  120 ° Use Global Light

Distance: 5 px

Choke: 0 %

Size: 51 px

Quality

Contour:  Anti-aliased

Noise: 4 %

| GRADIENT OVERLAY :

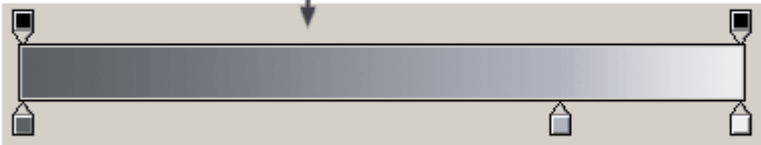
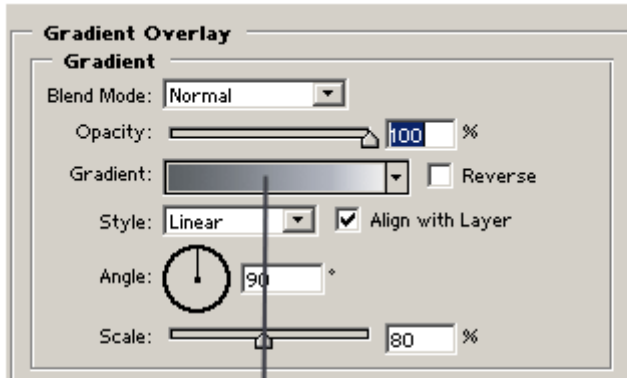

#5B6064

#B1B5BF #EEEEEE

| **STROKE :**

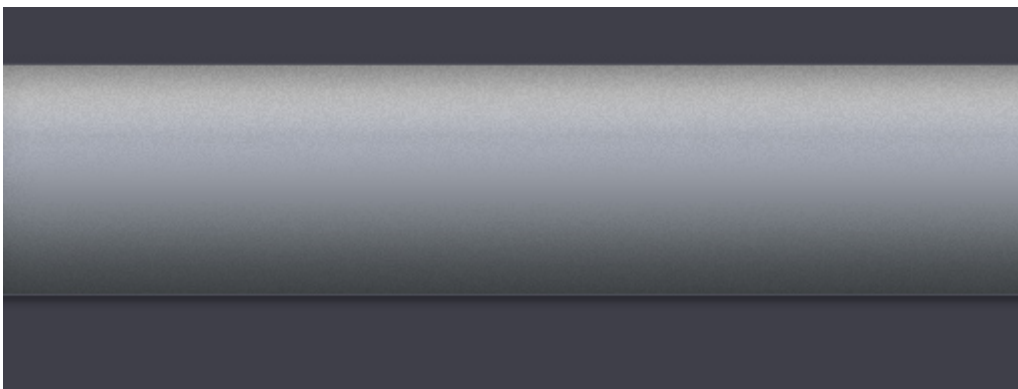
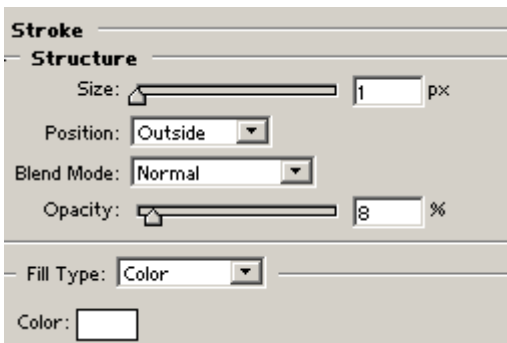

- Now select the **Rounded Rectangle Tool**, and set the **Radius to 60px**:



- Then draw a shape about similar size to mine.

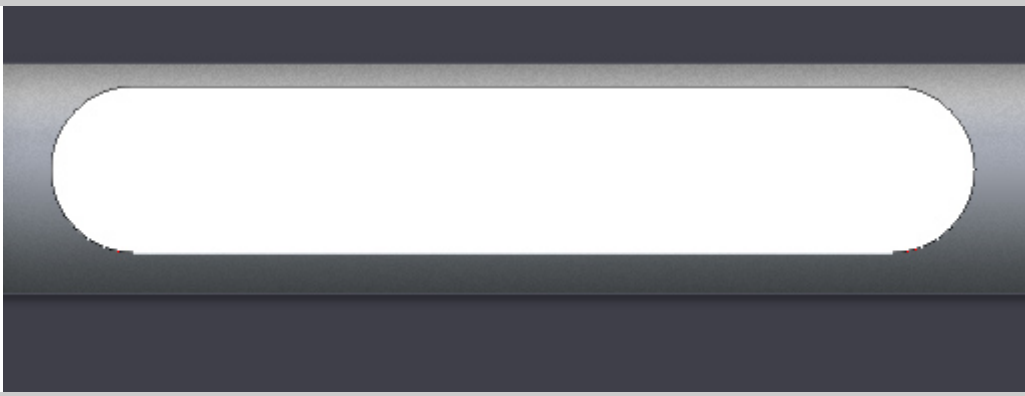

- Now go to **Edit->Transform->Skew**. This will give you handlers on each corner so you can resize/adjust the shape.
- Now use your cursor to pull the top right and left handle inside to give the sides a inward slant. Use your own judgement to make sure both sides slants equally.

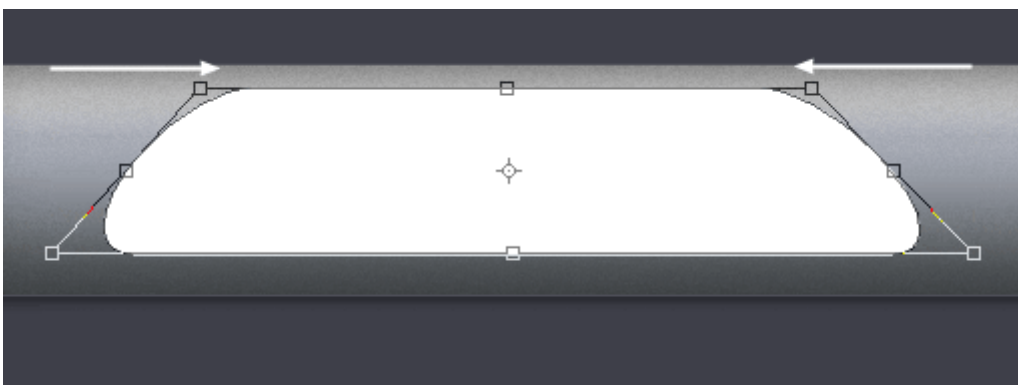

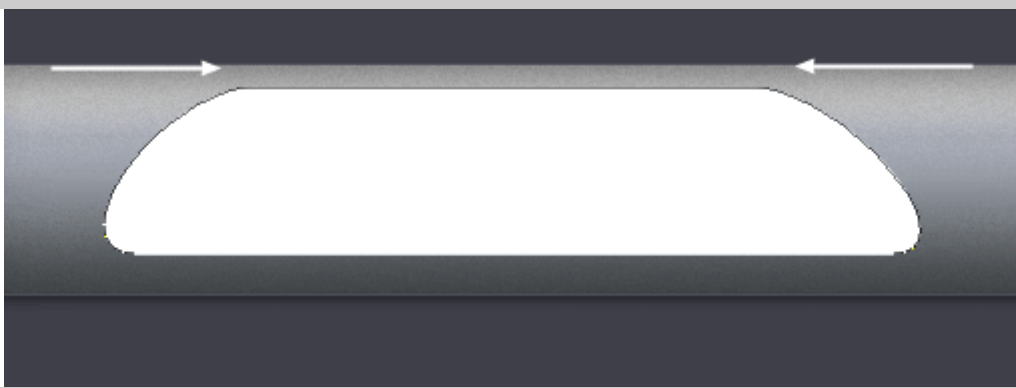

Now apply the following layer styles to this shape. **Layer->Layer Style**

DROP SHADOW:

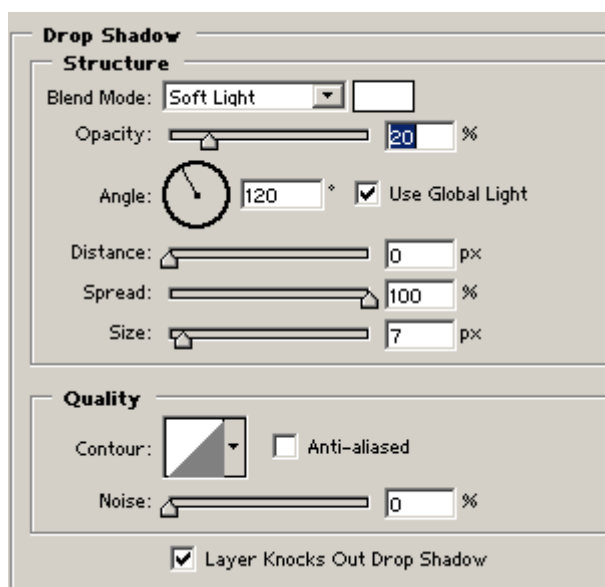

INNER SHADOW:

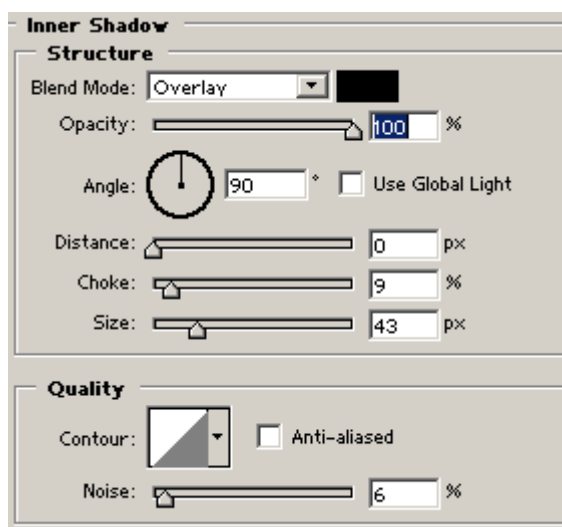

| GRADIENT OVERLAY:

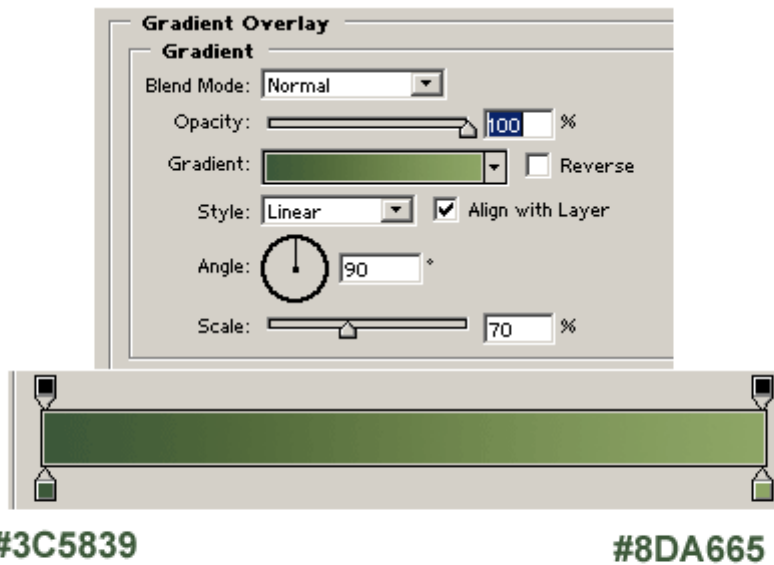

Note: For this step, you can use any color you like, but always use DARKER color on the left and LIGHTER color on the right, just like the colors above

| STROKE:

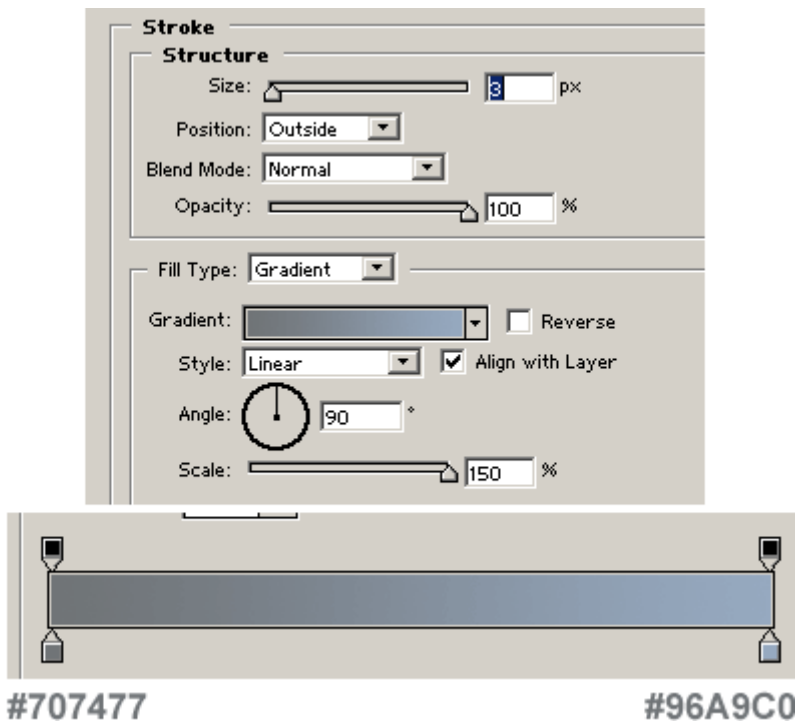

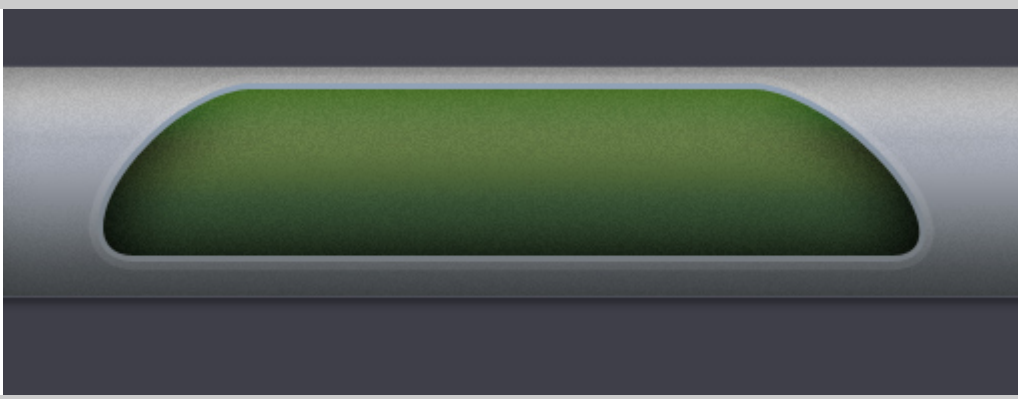

- Create a NEW LAYER
- Set your foreground color to WHITE,
- Now **CTRL+CLICK** on this layer to load the selection, then select the **Brush Tool**:



, set the brush size to **65 Soft Edge**:

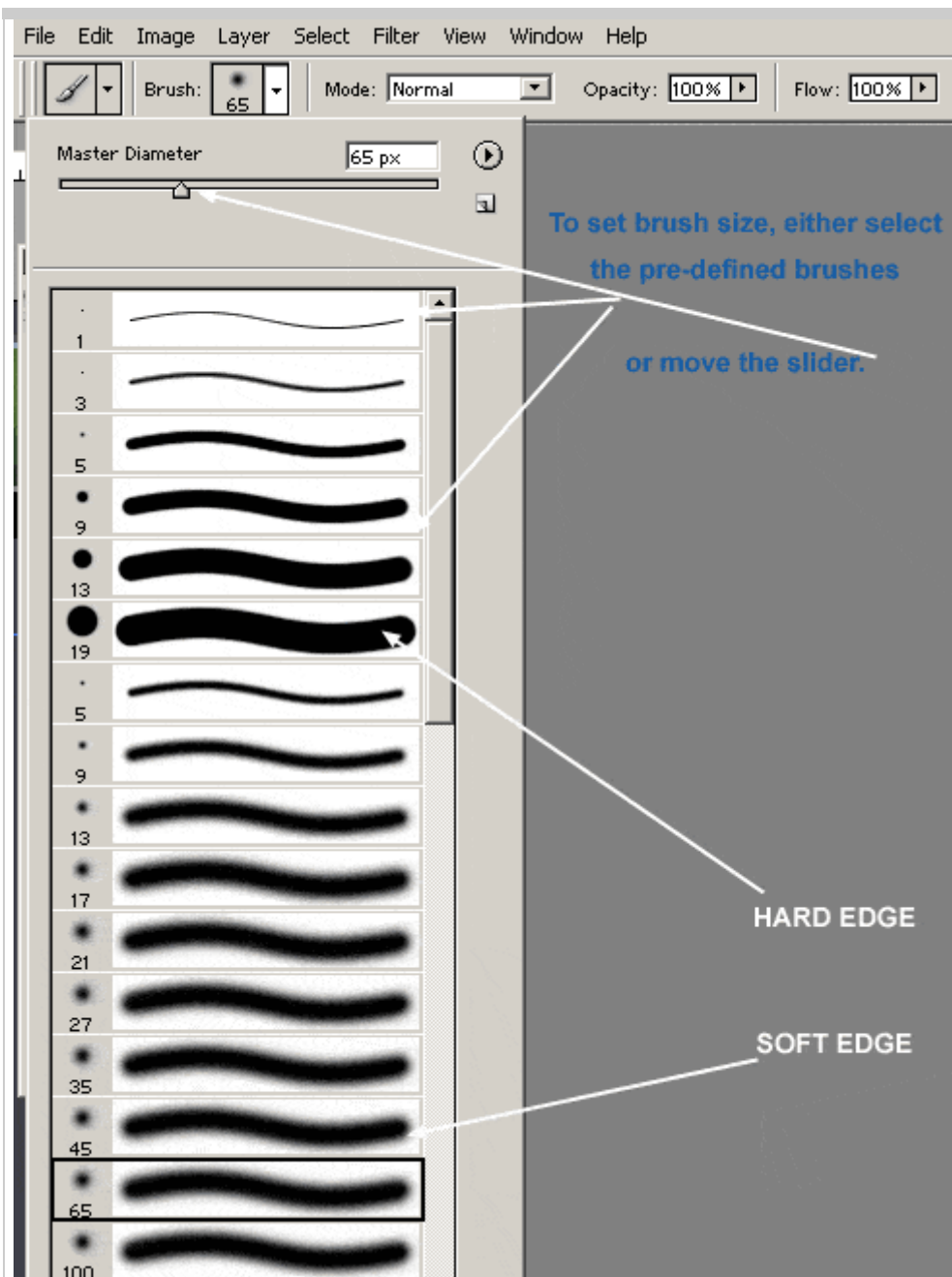

and make a straight stroke across the top edge of the selection. Start from outside the selection, then all the way through to outside the other end. (see image). Hold down shift while you do this to get a straight stroke.

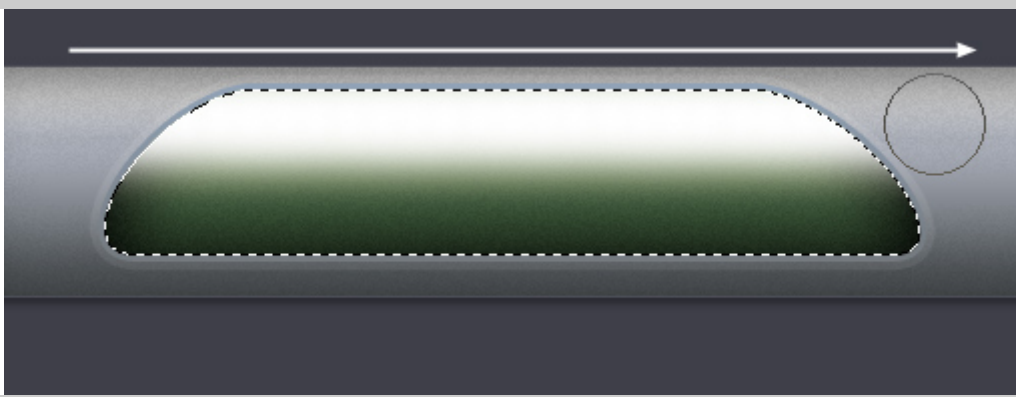

- **CTRL+D** to deselect.
- Now move this layer (the one you just brushed) up by about 3 or 4px.
- Now set the layer's opacity down to about 50%

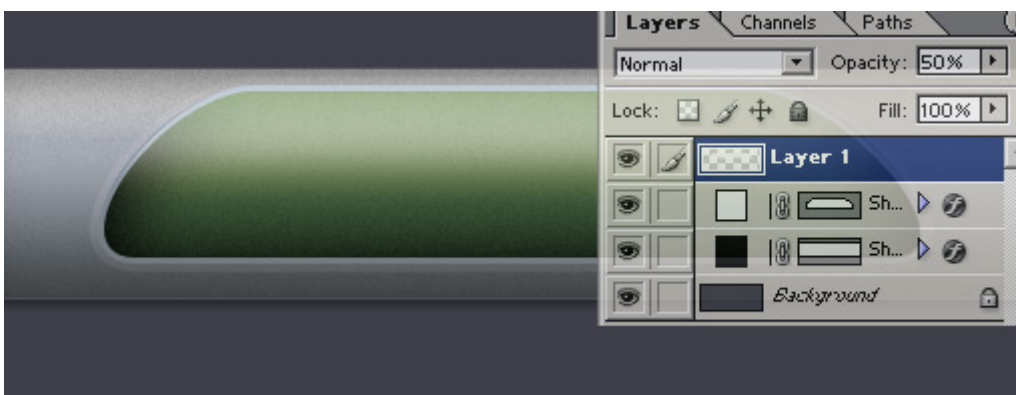

Now choose the rounded rectangle tool, set the radius to 20px, then draw a shape just near the top edge of the shape. Make it smaller than the shape and not to go outside it.

Then set this layer's **opacity** down to **20%**

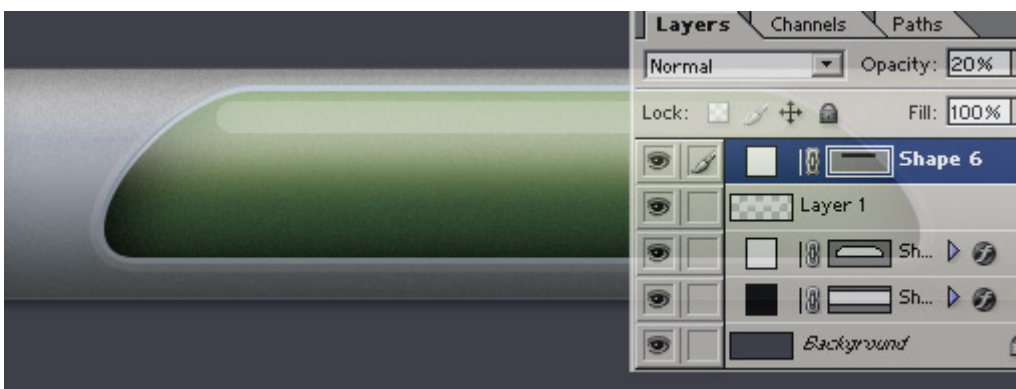

Now lets add some details to our pipe. choose (*by choose, i mean select it as the working layer in the layer's pallette, a working layer pallette is highlighted dark blue*) the pipe layer (the first layer we created), then go to **layer->rasterize->shape**.

Now, use the **rectangular marquee tool**:

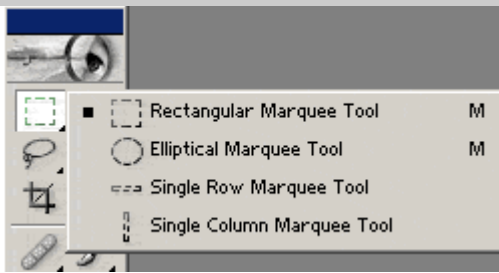

and make a 225 wide and 5px high selection on the bottom of the pipe.

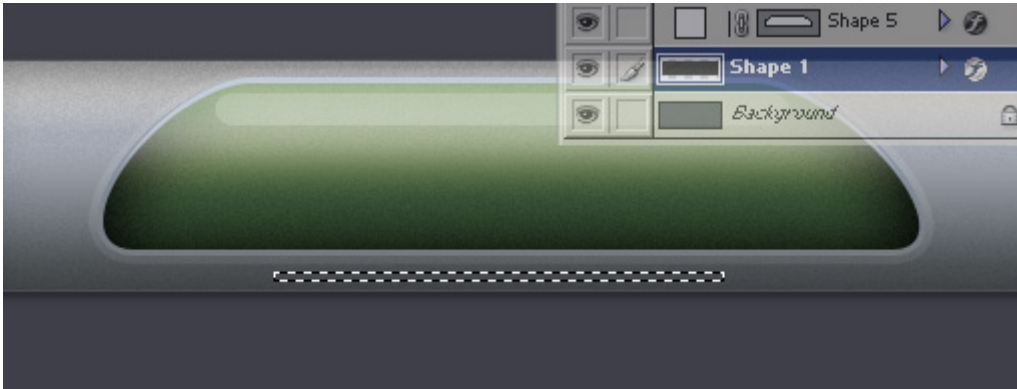

Now press DELETE, this will delete selected area of the pipe, but because it has some dropshadows on it, it will give it some depth.

now, use your imagination with the above step, create different size selections, different places. Note that this will only look good if done with thin selections, and a more towards the bottom of the pipe.

Now maybe you can add some wires to the interface to make it look hi-tech. Adding a wire is pretty easy.

- Create a new layer
- create a selection using the **circular marquee tool** (if you know how to use the pen tool, you can make more advanced wires).
- Go to **Edit->Stroke**, enter **3px**, and choose your wire's color.

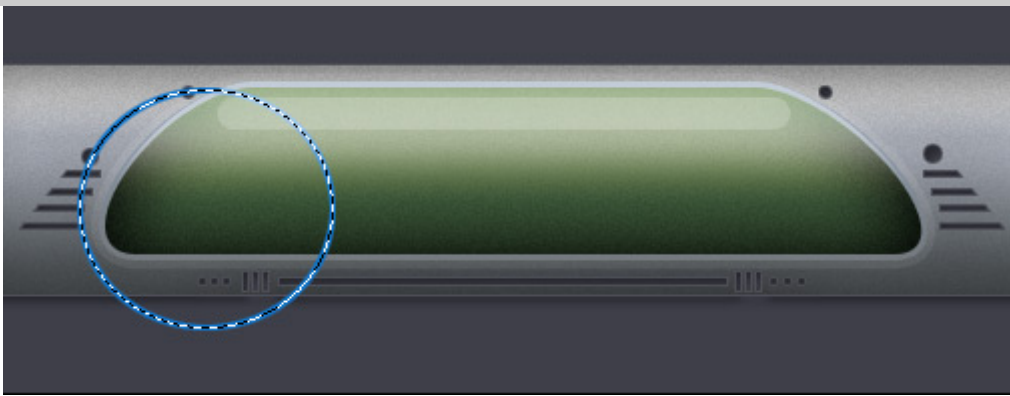

Then apply the following **Bevel and Emboss**:

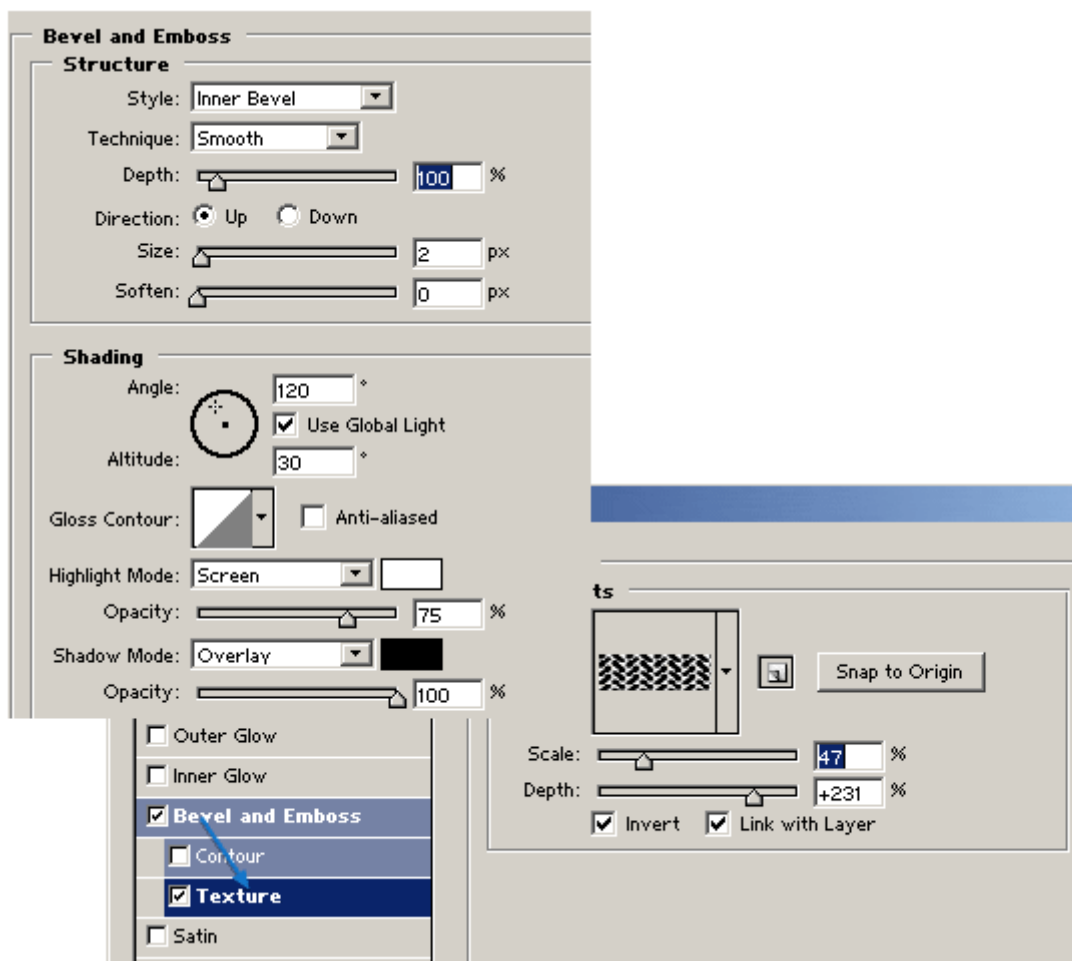

layer style to it. Now just use the eraser tool with **hard edge brush** and delete away the unwanted part of the wire.

Here is mine.

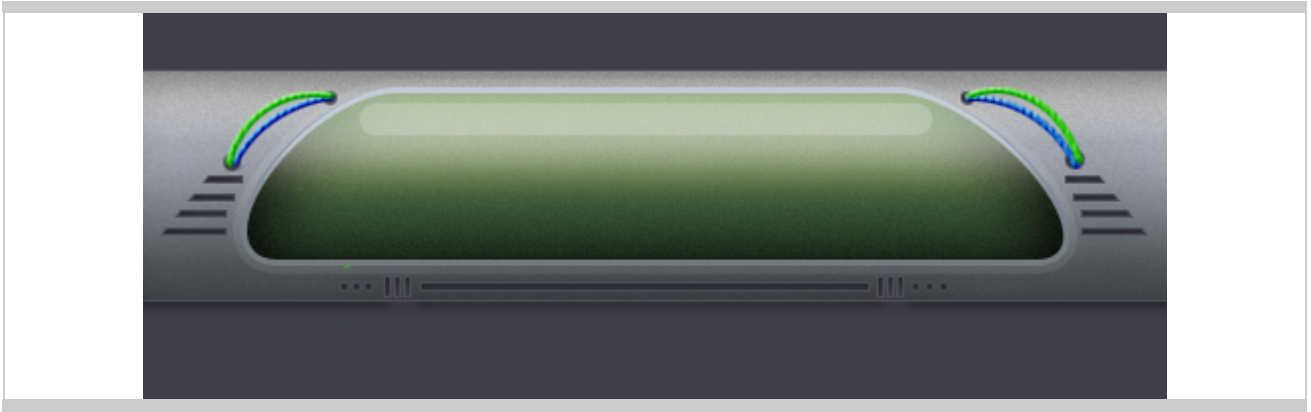

PDF By: **Bernawolf_hatef**

Sir_hatef@yahoo.com

www.Bernawolf.coM

Copyright © 2005 B.S.G (Bernawolf Software Group)